

Document Title		TPRO Battery Charger 30A Fuse Holder Check				
Document #	Rev	Type	Reason	Recommendation	Original Release Date	
ZSB-027	Original	Service Bulletin	Reliability	Mandatory	7/16/2020	

## TPRO Battery Charger 30A Fuse Holder Check

Applies to units produced prior to **TBD**

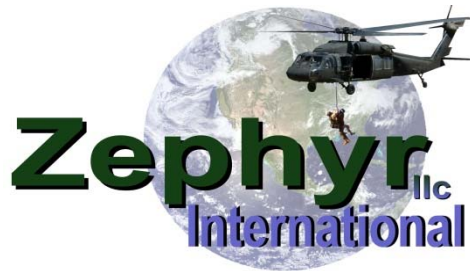

Zephyr International LLC  
 5015 Enoch Rd, Conway SC 29526 USA  
 Phone 843-365-2675 \* Fax 843-365-2677  
 Email: [info@zephyrintl.com](mailto:info@zephyrintl.com)  
 Web: [www.zephyrintl.com](http://www.zephyrintl.com)

Supporting Helicopter Rescue Hoist Users Worldwide

Prepared by	Jim Brown	<a href="mailto:jbrown@zephyrintl.com">jbrown@zephyrintl.com</a>
Checked by	Elizabeth Bielsa-Mitchell	<a href="mailto:zephyradmin@zephyrintl.com">zephyradmin@zephyrintl.com</a>
Approved by	Michael R Mitchell	<a href="mailto:mmitchell@zephyrintl.com">mmitchell@zephyrintl.com</a>

Document Title		TPRO Battery Charger 30A Fuse Holder Check				
Document #	Rev	Type	Reason	Recommendation	Original Release Date	
ZSB-027	Original	Service Bulletin	Reliability	Mandatory	7/16/2020	

**Purpose:** To advise users to check for a translucent green body color of the TPRO battery chargers 30A fuse and the TPRO battery charger 30A fuse holders for deformation.

**Illustrations:** fuse holder deformation and translucent green colored fuse body

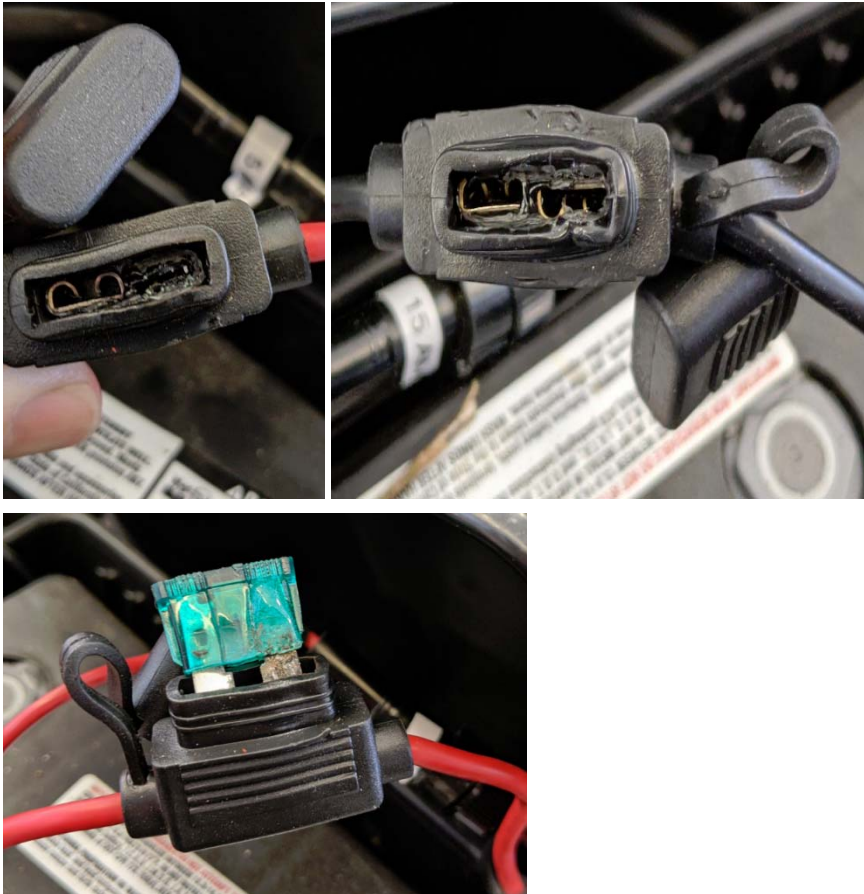

**Applies to units produced prior to *TBD***

**Scope:** The 30A fuse terminal legs for each lead on the battery charger can be susceptible to corrosion causing high resistance of the fuse leg and fuse holder connection. The high resistance can cause high heat which will deform the plastic fuse holder.

Suspect 30A fuse has a translucent green color of its body, users should check for this translucent green 30A fuse and for possible corrosion to the terminal legs.

Document Title		TPRO Battery Charger 30A Fuse Holder Check				
Document #	Rev	Type	Reason	Recommendation	Original Release Date	
ZSB-027	Original	Service Bulletin	Reliability	Mandatory	7/16/2020	

**Procedure:** Users can have the 30A translucent green body colored fuse replaced by contacting Zephyr International, LLC. Users should replace all 4 fuses. Each battery on the RHGSE has (2) fuse holders and (2) 30A fuses for each lead on the batteries.

If deformation of the fuse holders is evident; users should contact Zephyr International, LLC for replacement fuse holders and fuses.

**Illustration:** replacement fuse holder; Note the replacement 30A fuse will be a solid green body color.

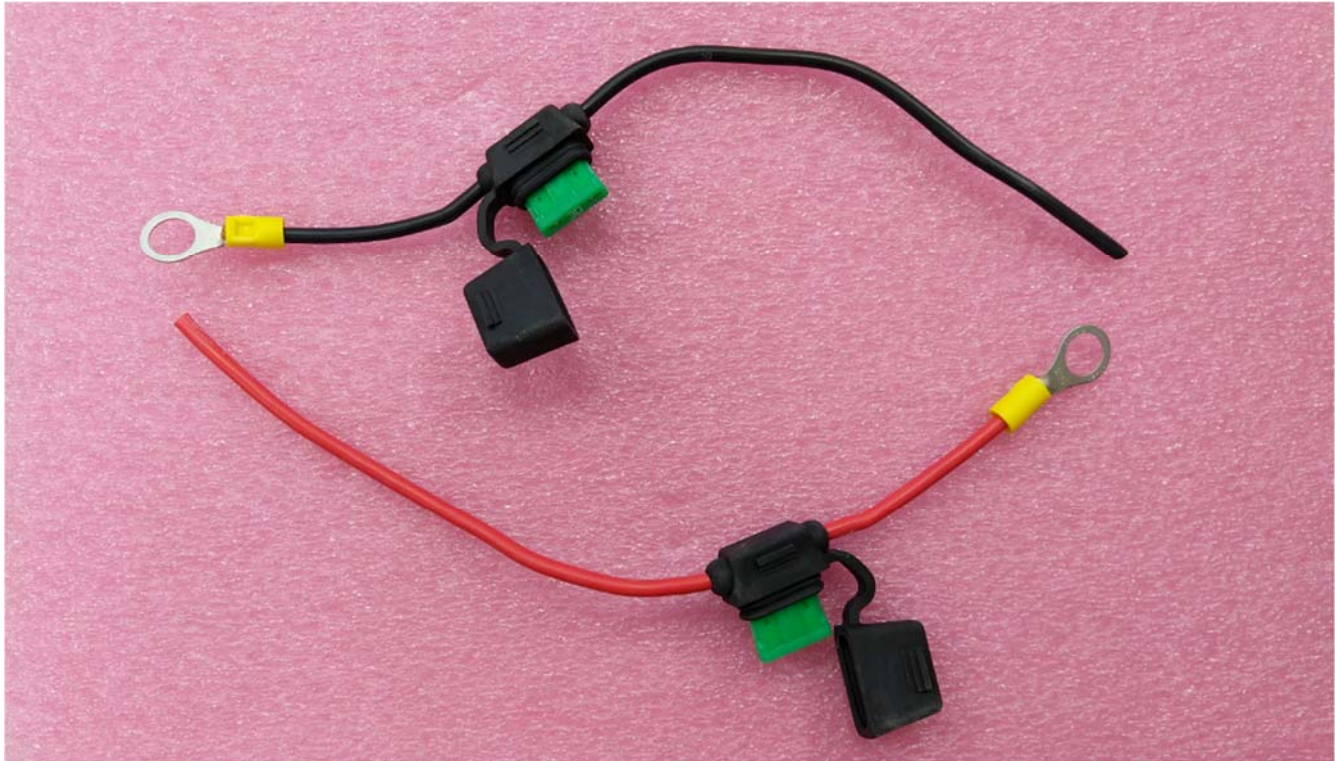

Document Title		TPRO Battery Charger 30A Fuse Holder Check				
Document #	Rev	Type	Reason	Recommendation	Original Release Date	
ZSB-027	Original	Service Bulletin	Reliability	Mandatory	7/16/2020	

To replace the fuse holders:

1. Disconnect the battery charger from its power source ensuring it is off and not charging a battery.
2. Disconnect the negative ring terminal (black lead) from the battery post; disconnect the positive ring terminal (red lead) from the battery post.
3. Cut each positive (red) and negative (black) lead wire at the damaged fuse holder, discard the fuse holder and ring terminal.
4. Butt splice connect replacement fuse holder and ring terminal to existing wire lead of appropriate color, heat shrinkable butt connector provided. Use a heat gun to shrink the ends of the butt connector once crimped/spliced to seal out the environment.
5. Ensure provided 30A fuse is seated in the fuse holder. Close fuse holder protective cap.
6. Re-connect the red lead ring terminal to the positive post of battery. Re-connect the negative lead ring terminal to the negative battery post. This step is for both onboard batteries.
7. Connect TPRO battery charger to appropriate power source.
8. Once the battery charger is powered up after step #6 & #7 monitor the status indicator lights on the battery charger to ensure proper function of each bank that is charging each battery.

**Conclusion:** If there is no deformation of the fuse holders caused by heat and users find the translucent green body colored fuses in the holders; the fuse only will need to be replaced.

**Price and Availability:** Contact Zephyr International for more information at [info@zephyrintl.com](mailto:info@zephyrintl.com) .